

STAGE 3 NOTES
EXISTING SANDPIT AND PLAY EQUIPMENT

- GENERAL**
- RELOCATE EXISTING X2 DOUBLE SWINGS FROM WITHIN SCHOOL GROUNDS. ENSURE FALLZONES MEET AS 4685
 - ROCK AND LOG EDGING AROUND EXISTING PLAY EQUIPMENT
- SANDPIT 2 (DETAIL 04-01)**
- EXISTING SANDPIT REDEVELOPED TO MEET STANDARDS
 - ROCK AND LOG EDGING
 - CARVED ROCK WITH RAINWELL HANDPUMP
- PATH**
- COMPACTED FINES PATH WITH TIMBER EDGE
- GRASS**
- IRRIGATED KIKUYU TURF
- CUBBY TEEPEES**
- NATURAL TIMBER TEEPEES. MAX INTERNAL HEIGHT 1600MM
- EXISTING PAVING**
- LIFT/RELAY EXISTING PAVING TO ENSURE NO PONDING
- PERGOLA**
- COVERED PERGOLA FOR OUTDOOR LEARNING OVER EXISTING PAVING

STAGE 4 NOTES
COURTYARD AND PERGOLA AREA

- SHADE SAIL**
- SHADE SAIL BETWEEN EXISTING PERGOLA AND BUILDING
- PICNIC BENCHES**
- TIMBER PARK BENCHES BENEATH EXISTING PERGOLA AS PER PLAN
- RAISED GARDEN AND TREE**
- RAISED MORTARED ROCK GARDEN BED AROUND SHADE TREE
- GARDEN BEDS**
- AT GROUND LEVEL
 - ENSURE EDGING INTACT
- BENCHES**
- ALUMINIUM BENCHES AS PER PLAN

- GENERAL NOTES**
- ARBORIST ASSESSMENT OF TREES PART OF AND ADJACENT TO PLAY SPACE TO BE UP TO DATE BY SCHOOL. RECOMMENDATIONS COMPLETED PRIOR TO COMMENCEMENT OF WORKS
 - SEARCH OF UNDERGROUND SERVICES REQUIRED BY CONTRACTOR PRIOR TO COMMENCEMENT OF WORKS
 - DIMENSIONS AND LEVELS TO BE CONFIRMED ON SITE BY CONTRACTOR TO ENSURE SET OUT IS ACCURATE AND COMPLIANT WITH AS 4685
 - SEEK APPROVAL IF MODIFICATION OF THE DESIGN IS REQUIRED DUE TO SERVICES, VEGETATION OR ANY UNFORESEEN CIRCUMSTANCES
 - THE CONTRACTOR IS RESPONSIBLE FOR MAKING GOOD ANY DAMAGES ON SITE AT THEIR EXPENSE
 - THE CONTRACTOR IS RESPONSIBLE FOR ALL PEDESTRIAN AND SITE TRAFFIC, MAINTAINING SITE SAFETY, INCLUDING APPROPRIATE FENCING TO PREVENT STUDENT ACCESS INTO THE SITE DURING WORKS

- ENTRAPMENT**
- ENSURE PLAYSPACE FREE FROM BODY ENTRAPMENTS AS PER AS 4685
 - PROTRUDING STICKS ROUNDED AND FREE FROM SPLINTERS

- ROCKS AND LOGS**
- LOGS EMBEDDED INTO SOIL BY $\frac{1}{3}$, PAINTED WITH BITUMEN PAINT AND PINNED INTO EARTH WHERE REQUIRED
 - STABILISE AND MORTAR ROCKS WHERE REQUIRED
 - EDGES OF ROCKS AND LOGS ROUNDED AS PER AS 4685
 - STEPPING LOGS EMBEDDED IN CONCRETE 300MM. BITUMEN PAINT PAINTED WHERE LOG BURIED

- TIMBER**
- ALL TIMBER TO BE FSC CERTIFIED OR SUITABLE RECLAIMED HARDWOOD. NO RAINFOREST TIMBERS TO BE USED
 - LOGS EMBEDDED INTO SOIL BY $\frac{1}{3}$ AND PINNED INTO EARTH WHERE REQUIRED
 - UPRIGHT TIMBERS TO BE EMBEDDED IN CONCRETE WITH BITUMEN PAINT TO SURFACES IN NATURAL GROUND. HEIGHT OF PAINT TO CORRELATE WITH VISUAL MARKER OF FINISHED SOFTFALL LEVEL.
 - ALL RECLAIMED HARDWOOD TO BE NATURALLY SEASONED

- PATHS (SEE DETAIL 06-01)**
- 1500MM WIDE MIN. COMPACTED FINES PATH
 - COMPACTED RUBBLE SUB BASE MIN 50mm
 - TOPPED WITH FITZGERALD SAND MIN. 70mm COMPACTED TO 98%. CROWN CENTRE TO AVOID PONDING. SWEEP TOP SURFACE AFTER COMPACTION TO REMOVE LOOSE PARTICLES.

- FALLZONES**
- 300MM SOFTFALL TO MEET A.S. 4685 WHERE INDICATED WHERE FHOF >600MM OR WHERE FORCED MOVEMENT EXISTS.
 - 1500MM IMPACT AREA WHEN EQUIPMENT/NATURAL PLAY ELEMENTS <600MM

- EDGING**
- TIMBER EDGING AROUND GARDEN BEDS UNLESS SPECIFIED OTHERWISE

ACHIEVE EVEN TRANSITION OF LEVELS AND ENSURE WATER DOES NOT POND AGAINST PATH

150MM SHOULDER IF NO EDGING INDICATED ON PLAN

70MM MIN LAYER WET QUARRY FINES COMPACTED TO APPROX. 98% MDD

50MM MIN. LAYER QUARRY RUBBLE (PM2 / 200G) COMPACTED TO MIN 89% MDD

STRIPPED SUBGRADE COMPACTED TO 98% STANDARD DENSITY TO AS1289. PROOF ROLLED TO REMOVE SOFT SPOTS AND REINSTATE USING COMPACTED GRANULAR MATERIAL MIN. CBR OF 5% (SATURATED) TO BE ACHIEVED

ACCEPTABLE ALTERNATIVE TO ONE WAY CROSS FALL IS TO CROWN THE CENTRE OF THE PATH ENSURING FALL TOWARDS GARDEN BED OR STORMWATER OUTLET

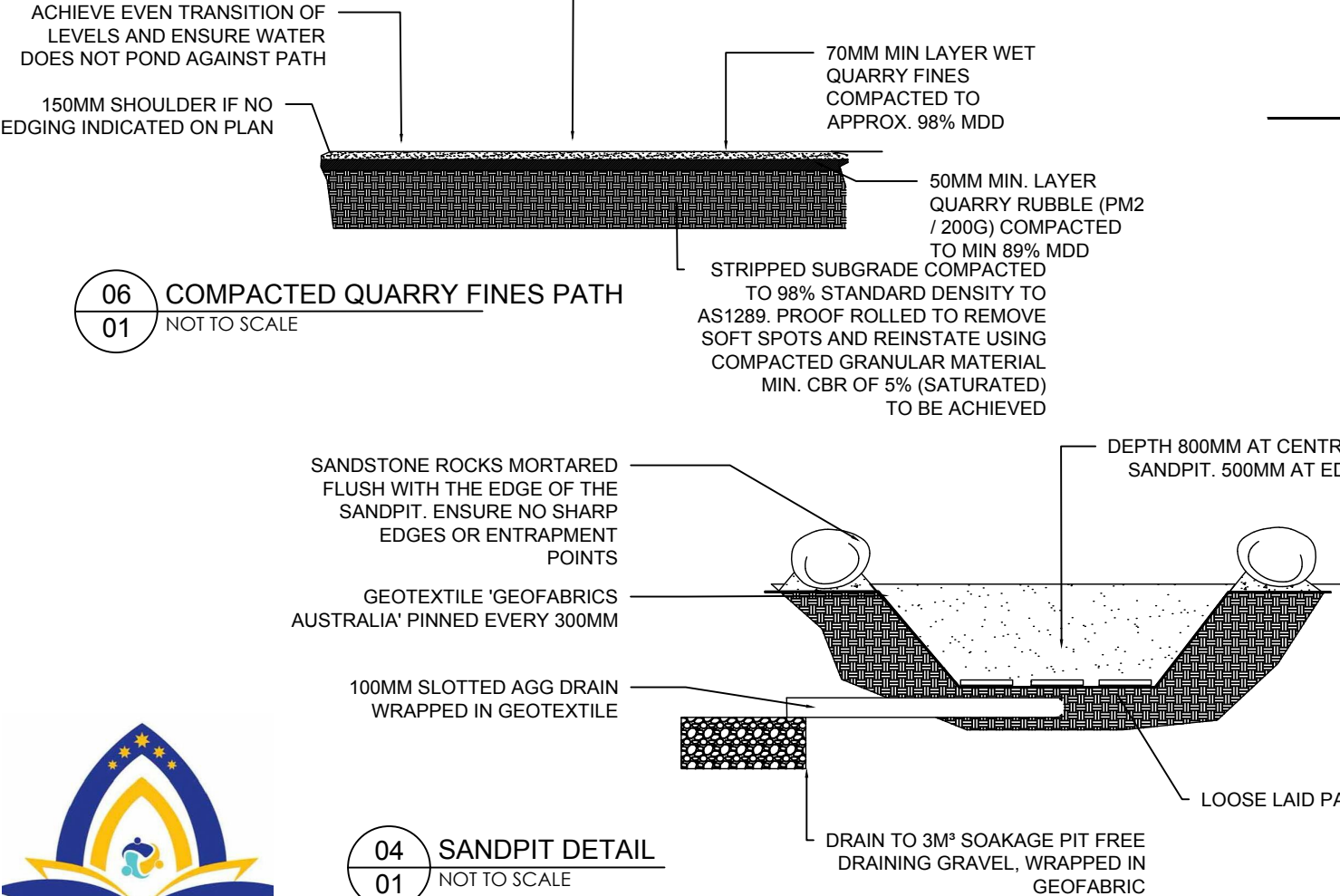

OUTDOOR PLAYSPACE DESIGN

PLAYFORD COLLEGE
24 DARRINGTON ROAD
ELIZABETH S112 SA

MASTERPLAN
DWG NO: 039-01
14.05.2020

RACHEL DRUMMOND
e:design@dirtyworklandscapes.com.au
m: 0400 887 366

DRAWINGS ARE ARTISTS IMPRESSIONS FOR DESIGN PURPOSES ONLY. ALL MEASUREMENTS TO BE VERIFIED ON SITE BY CONTRACTORS

0 1 2 3 4 5 6 7 8 9 10
1:200 @ A2

N

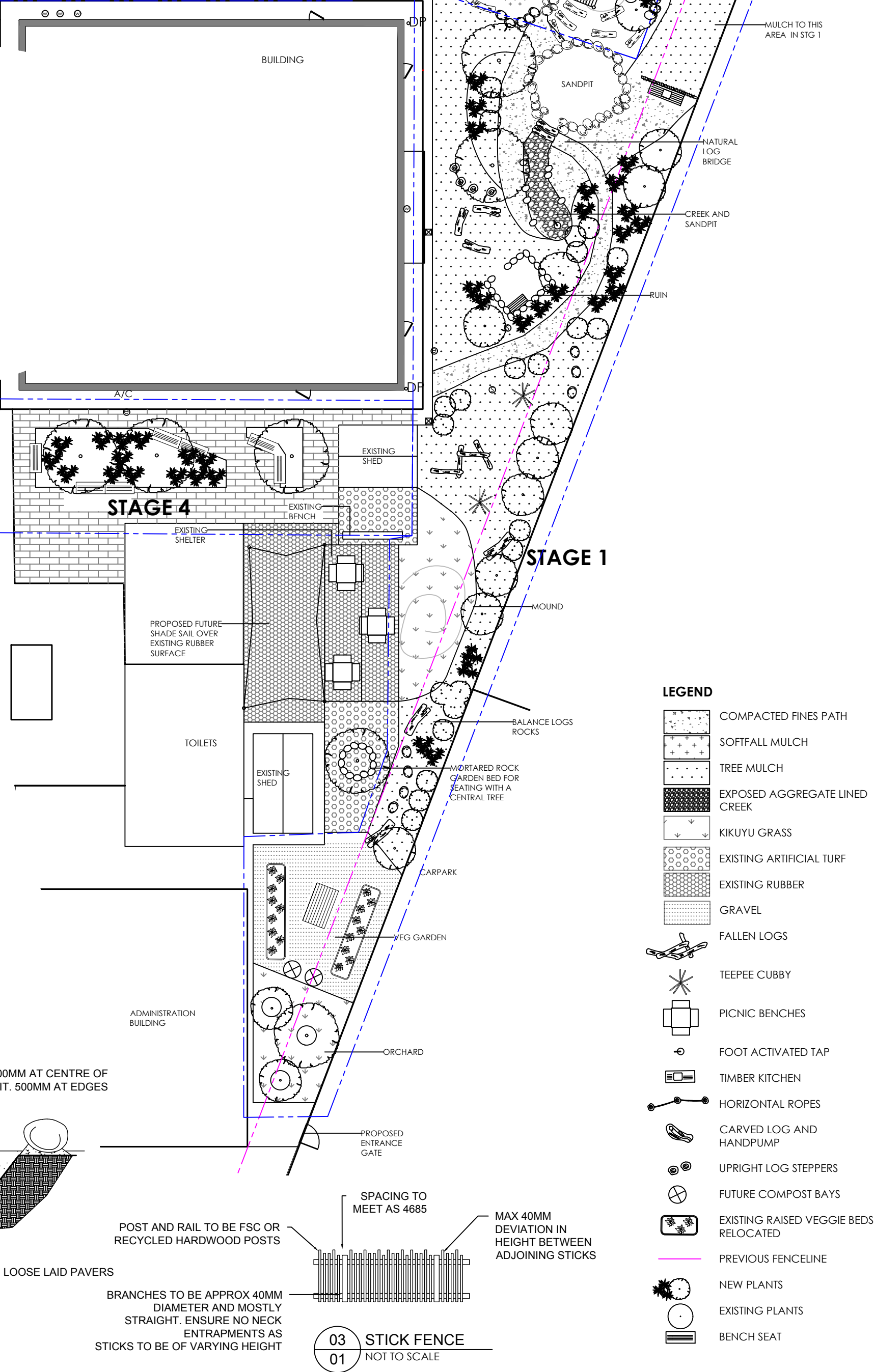

- LEGEND**
- COMPACTED FINES PATH
 - SOFTFALL MULCH
 - TREE MULCH
 - EXPOSED AGGREGATE LINED CREEK
 - KIKUYU GRASS
 - EXISTING ARTIFICIAL TURF
 - EXISTING RUBBER
 - GRAVEL
 - FALLEN LOGS
 - TEEPEE CUBBY
 - PICNIC BENCHES
 - FOOT ACTIVATED TAP
 - TIMBER KITCHEN
 - HORIZONTAL ROPES
 - CARVED LOG AND HANDPUMP
 - UPRIGHT LOG STEPPERS
 - FUTURE COMPOST BAYS
 - EXISTING RAISED VEGGIE BEDS RELOCATED
 - PREVIOUS FENCELINE
 - NEW PLANTS
 - EXISTING PLANTS
 - BENCH SEAT

GENERAL NOTES

- ARBORIST ASSESSMENT OF TREES PART OF AND ADJACENT TO PLAY SPACE TO BE UP TO DATE BY SCHOOL. RECOMMENDATIONS COMPLETED PRIOR TO COMMENCEMENT OF WORKS
- SEARCH OF UNDERGROUND SERVICES REQUIRED BY CONTRACTOR PRIOR TO COMMENCEMENT OF WORKS
- DIMENSIONS AND LEVELS TO BE CONFIRMED ON SITE BY CONTRACTOR TO ENSURE SET OUT IS ACCURATE AND COMPLIANT WITH AS 4685
- SEEK APPROVAL IF MODIFICATION OF THE DESIGN IS REQUIRED DUE TO SERVICES, VEGETATION OR ANY UNFORESEEN CIRCUMSTANCES
- THE CONTRACTOR IS RESPONSIBLE FOR MAKING GOOD ANY DAMAGES ON SITE AT THEIR EXPENSE
- THE CONTRACTOR IS RESPONSIBLE FOR ALL PEDESTRIAN AND SITE TRAFFIC, MAINTAINING SITE SAFETY, INCLUDING APPROPRIATE FENCING TO PREVENT STUDENT ACCESS INTO THE SITE DURING WORKS

ENTRAPMENT

- ENSURE PLAYSPACE FREE FROM BODY ENTRAPMENTS AS PER AS 4685
- PROTRUDING STICKS ROUNDED AND FREE FROM SPLINTERS

ROCKS AND LOGS

- LOGS EMBEDDED INTO SOIL BY $\frac{1}{3}$, PAINTED WITH BITUMEN PAINT AND PINNED INTO EARTH WHERE REQUIRED
- STABILISE AND MORTAR ROCKS WHERE REQUIRED
- EDGES OF ROCKS AND LOGS ROUNDED AS PER AS 4685
- STEPPING LOGS EMBEDDED IN CONCRETE 300MM. BITUMEN PAINT PAINTED WHERE LOG BURIED

TIMBER

- ALL TIMBER TO BE FSC CERTIFIED OR SUITABLE RECLAIMED HARDWOOD. NO RAINFOREST TIMBERS TO BE USED
- LOGS EMBEDDED INTO SOIL BY $\frac{1}{3}$ AND PINNED INTO EARTH WHERE REQUIRED
- UPRIGHT TIMBERS TO BE EMBEDDED IN CONCRETE WITH BITUMEN PAINT TO SURFACES IN NATURAL GROUND. HEIGHT OF PAINT TO CORRELATE WITH VISUAL MARKER OF FINISHED SOFTFALL LEVEL.
- ALL RECLAIMED HARDWOOD TO BE NATURALLY SEASONED

PATHS

- 1500MM WIDE MIN. COMPACTED FINES PATH
- COMPACTED RUBBLE SUB BASE MIN 50mm
- TOPPED WITH FITZGERALD SAND MIN. 70mm COMPACTED TO 98%. CROWN CENTRE TO AVOID PONDING. SWEEP TOP SURFACE AFTER COMPACTION TO REMOVE LOOSE PARTICLES.

FALLZONES

- 300MM SOFTFALL TO MEET A.S. 4865 WHERE INDICATED WHERE FHOF >600MM OR WHERE FORCED MOVEMENT EXISTS.
- 1500MM IMPACT AREA WHEN EQUIPMENT/NATURAL PLAY ELEMENTS <600MM

EDGING

- TIMBER EDGING AROUND GARDEN BEDS UNLESS SPECIFIED OTHERWISE

STAGE 1 NOTES

GENERAL

- EASEMENT BETWEEN OLD FENCE LINE AND NEIGHBOUR FENCE
- EXISTING ARTIFICIAL TURF AND RUBBER EDGING REQUIRES FINISHING/FIXING
- CONCRETE GUTTER REQUIRES FIXING

RAISED VEGETABLE GARDEN BEDS

- RELOCATED EXISTING BEDS. STRAIGHTEN AND APPLY RUBBER OR SIMILAR ON TOP EDGE.
- FILLED WITH VEGETABLE GARDEN SOIL

POTTING BENCH

- 2100MM X 1200MM HARDWOOD TIMBER BENCH OR SIMILAR. 700MM HIGH

ORCHARD

- IRRIGATED KIKUYU GRASS
- 1M CIRCUMFERENCE WITH EDGING AROUND FRUIT TREES

TEEPEE CUBBY

- NATURAL TIMBER TEEPEES. MAX INTERNAL HEIGHT 1600MM

CUBBY RUIN (IMAGE 05-02)

- MORTARED QUARRIED STONE WALL TO MAX 500MM HIGH
- TIMBER SLAB BENCH AND GRILL INSIDE
- UPRIGHT TIMBER DOOR FRAME

STEPPING LOGS AND ROCKS

- VERTICAL LOGS BETWEEN 200-600MM
- RANDOMLY SPACE FOR JUMPING BETWEEN, MAX DISTANCE 1M

CREEK

- SELF LIMITING LOW FLOW FOOT TAP CONCEALED IN A SERVICEABLE TIMBER BASE AND SPOUT ATTACHED TO AN UPRIGHT HARDWOOD TIMBER LOG.
- EXPOSED AGGREGATE CREEK WITH LARGE ROCKS PLACED RANDOMLY TO MIMIC A CREEK. LARGE LOGS ACROSS CREEK AS INFORMAL BRIDGES.

BRIDGE

- NATURAL FALLEN LOGS OVER CREEK AS BRIDGE. ENSURE NO FOOT ENTRAPMENTS

FALLEN LOGS

- <600MM HIGH. DEBARK, PIN AND ROUND ENDS. 1500MM IMPACT AREA SURROUNDING LOGS.
- MIN. LOG SIZE 150MM

OUTDOOR KITCHEN (SEE DETAIL 01- 02)

- TIMBER OUTDOOR KITCHEN WITH SINK AND PREPARING SPACE
- 1500MM X 400MM HARDWOOD WITH LOWER SHELF AND SPLASH BACK
- 600MM HIGH

STICK FENCE (SEE DETAIL 03- 01)

SANDPIT (SEE DETAIL 04- 01)

- LOCAL MORTARED QUARRY ROCK EDGE.



05
02 RUIN

STAGE 2 NOTES

MOUND

- ROCKS AND LOGS EMBEDDED IN MOUND, FINISHED WITH COMPACTED FINES
- IRRIGATED PLANTS TO MOUND

CUBBY/FORT (SEE DETAIL 05- 02)

- HARDWOOD TIMBER FORT WITH A MIX OF TIMBER SLAT AND NATURAL STICK BALUSTRADE
- VERTICAL MORTARED ROCKS AT EDGE OF MOUND TO CREATE A TUNNEL BENEATH CUBBY

SLIDE

- 1.2m FIBREGLASS SLIDE
- INSTALL AS PER MANUFACTURERS GUIDELINES AS PER AS 4685

LOG SCRAMBLE/HORIZONTAL ROPES (SEE DETAIL 02-02)

- ROPE AND TIMBER TO AS 4685
- SIZE OF EQUIPMENT DETERMINED BY FALLZONE AVAILABILITY

LEGEND

- COMPACTED FINES PATH
- SOFTFALL MULCH
- TREE MULCH
- EXPOSED AGGREGATE LINED CREEK
- KIKUYU GRASS
- EXISTING ARTIFICIAL TURF
- EXISTING RUBBER
- GRAVEL
- FALLEN LOGS
- TEEPEE CUBBY
- PICNIC BENCHES
- FOOT ACTIVATED TAP
- TIMBER KITCHEN
- HORIZONTAL ROPES
- CARVED LOG AND HANDPUMP
- UPRIGHT LOG STEPPERS
- FUTURE COMPOST BAYS
- EXISTING RAISED VEGGIE BEDS RELOCATED
- PREVIOUS FENCELINE
- NEW PLANTS
- EXISTING PLANTS
- BENCH SEAT

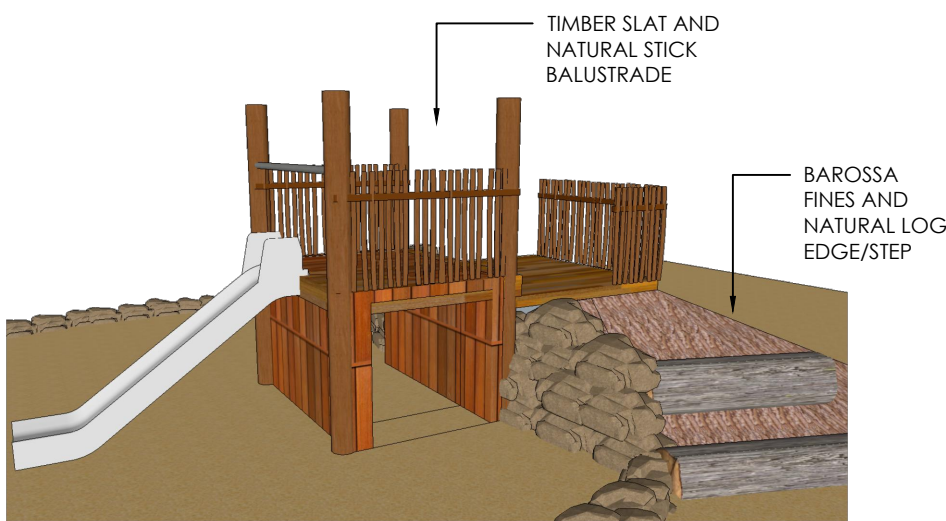
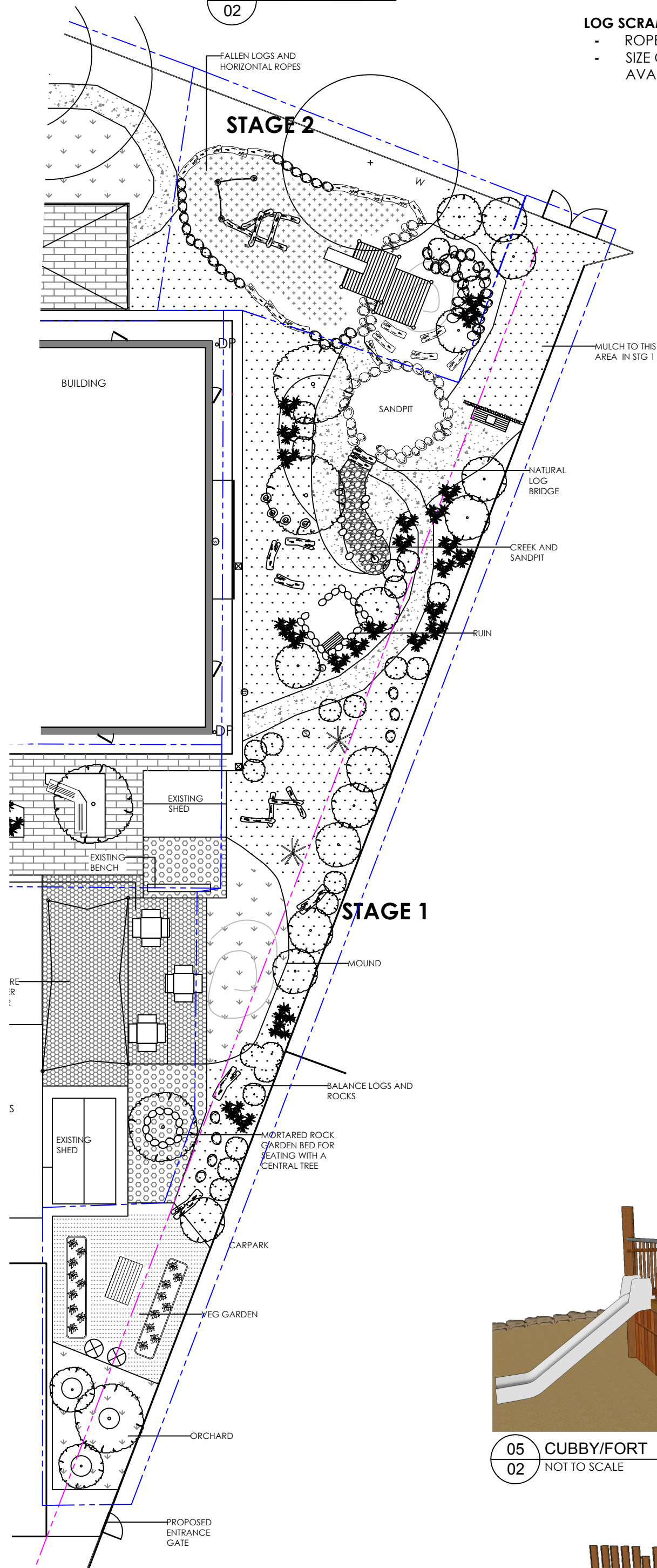

05
02 CUBBY/FORT
NOT TO SCALE

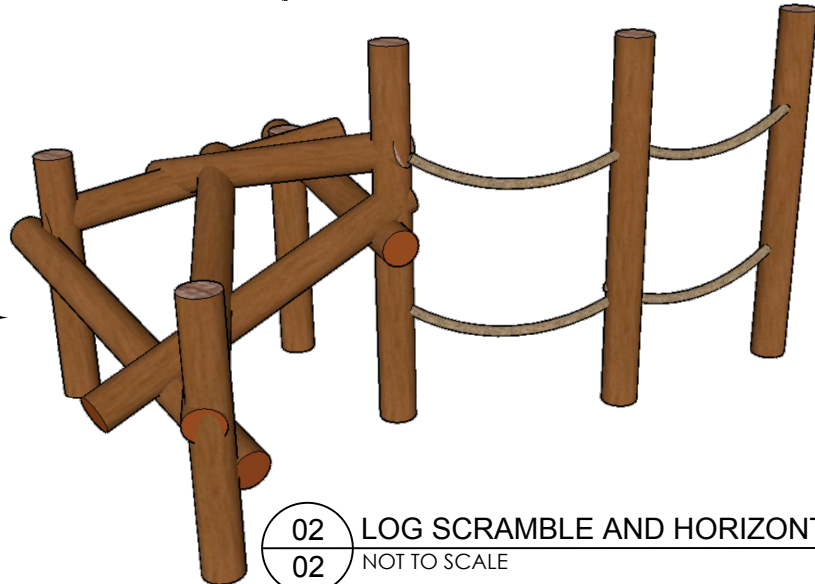

02
02 LOG SCRAMBLE AND HORIZONTAL ROPES
NOT TO SCALE



01
02 KITCHEN
NOT TO SCALE



OUTDOOR PLAYSACE DESIGN

PLAYFORD COLLEGE
24 DURRENDRIDGE ROAD
ELIZABETH 5112 SA

CONSTRUCTION
PLAN STAGE 1 & 2
DWG NO: 039-02

RACHEL DRUMMOND
e: design@dirtyworklandscapes.com.au
m: 0400 887 366

DRAWINGS ARE ARTISTS IMPRESSIONS
FOR DESIGN PURPOSES ONLY. ALL
MEASUREMENTS TO BE VERIFIED ON SITE
BY CONTRACTORS

14.05.2020
1:2000 S/A2

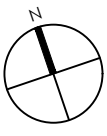

PLANTING SCHEDULE

Orchard plants

Cir	Citrus reticulata
Pug	Punica granatum
Mos	Morus alba

Mandarin
Pomegranate
'Shahtoot' Mulberry

Trees

Alv	<i>Allocausuarina verticillata</i>
Cav	<i>Callistemon viminalis</i>
Cua	<i>Cupaniopsos anacardiodes</i>
Euc	<i>Eucalyptus caesia</i>

Drooping Sheoak
Bottlebrush
Tuckeroo
Gungurru

Small plants/Groundcovers

Cor	Correa reflexa
Goa	Goodenia amplexans
Kep	Kennedia prostrata
Sea	Senna artemisioides ssp filifolia
Wef	Westringia fruticosa

Native Fuschia
Clasping goodenia
Running Postman
Punty bush
'Smokie'Coastal Rosemary

Large Shrubs

Acp	Acacia pycnantha
Acm	Acacia myrtifolia
Ads	Adenanthos sericeus
Bam	Banksia marginata
Bus	Bursaria spinosa
Dov	Dodonaea viscosa
Erm	Eremophila maculata
Gro	Grevillea olivacea
Men	Melaleuca nesophila

Golden Wattle
Myrtle Wattle
'Silver Silk' Woolly Bush
Silver Banksia
Sweet bursaria, Christmas Bush
Sticky Hop Bush
Spotted Emu Bush
Olive Leaf Grevillea
Little Nussy' Showy Honey-myrtle

Grasses

Cyv	<i>Cyperus vaginatus</i>
Fin	<i>Ficinia nodosa</i>
Lon	<i>Lomandra nyalla</i>
Tht	<i>Themeda triandra</i>

Stiff flat-sedge
Knobby Club-rush
Spiny Headed Mat-Rush
Kangaroo Grass

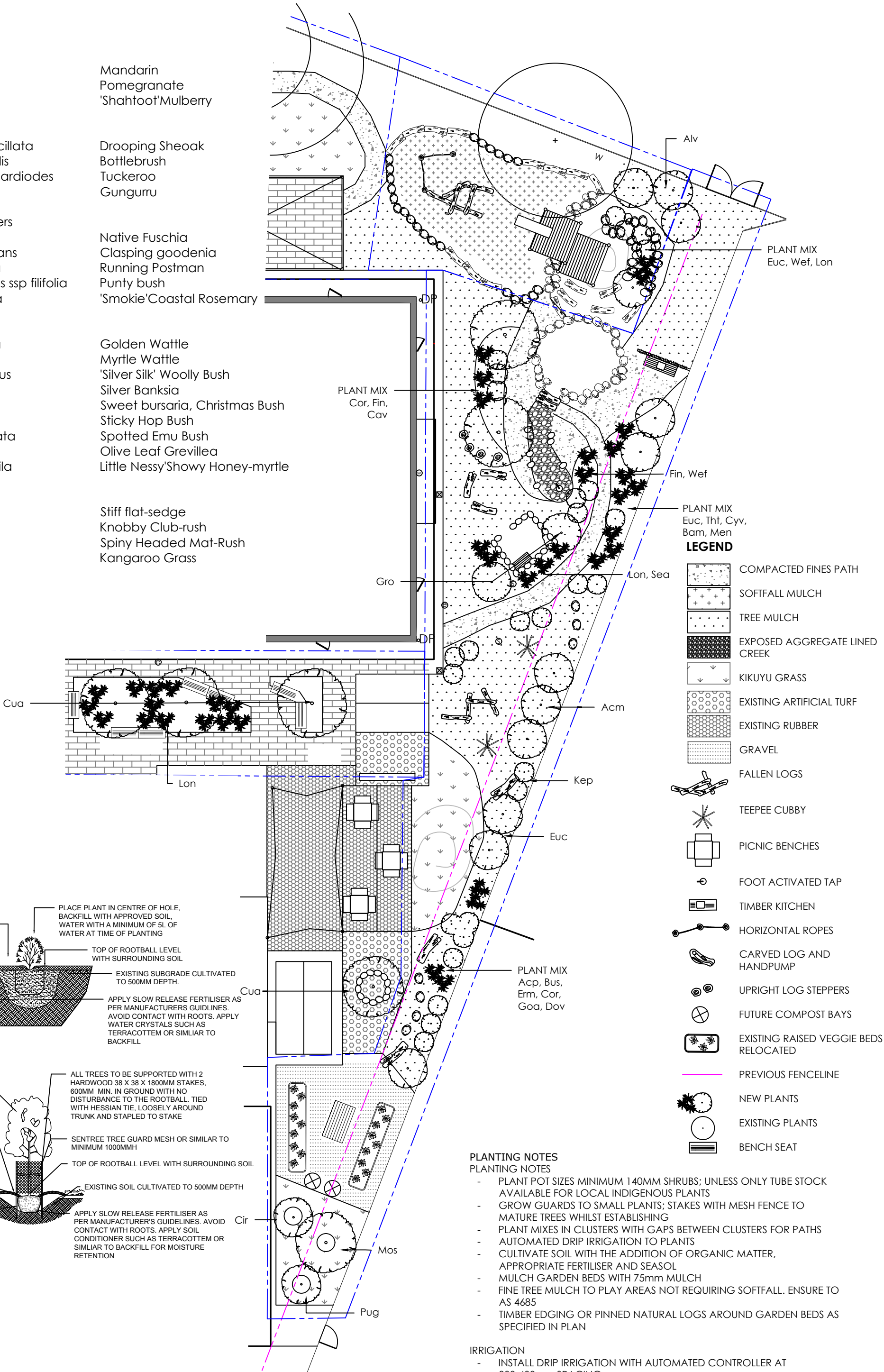

PLANTING DETAILS

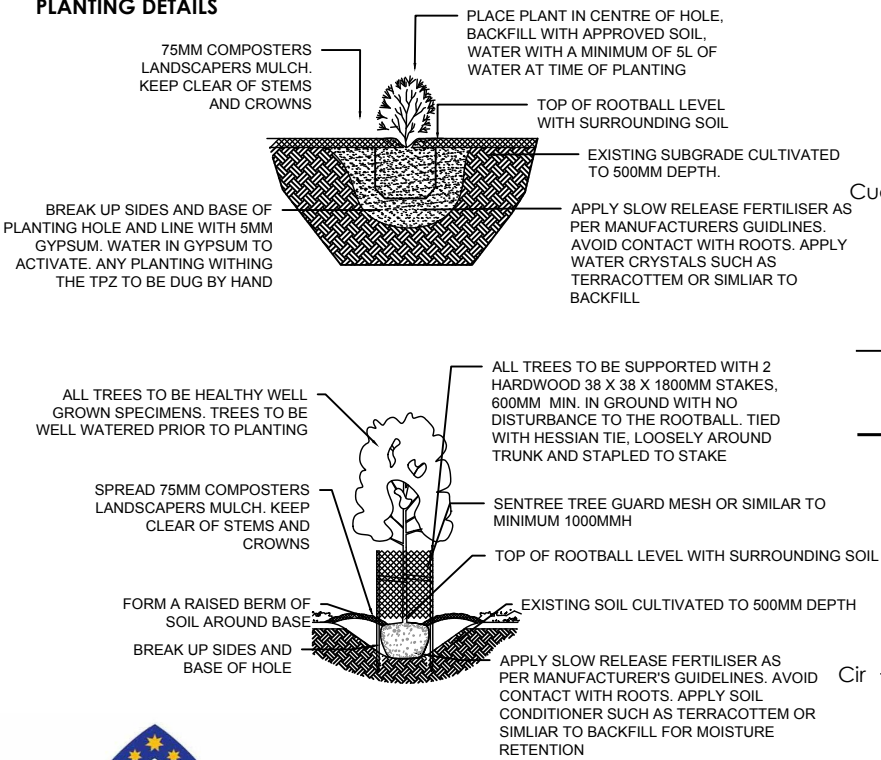

PLANTING NOTES

PLANTING NOTES

- PLANT POT SIZES MINIMUM 140MM SHRUBS; UNLESS ONLY TUBE STOCK AVAILABLE FOR LOCAL INDIGENOUS PLANTS
- GROW GUARDS TO SMALL PLANTS; STAKES WITH MESH FENCE TO MATURE TREES WHILST ESTABLISHING
- PLANT MIXES IN CLUSTERS WITH GAPS BETWEEN CLUSTERS FOR PATHS
- AUTOMATED DRIP IRRIGATION TO PLANTS
- CULTIVATE SOIL WITH THE ADDITION OF ORGANIC MATTER, APPROPRIATE FERTILISER AND SEASOL
- MULCH GARDEN BEDS WITH 75mm MULCH
- FINE TREE MULCH TO PLAY AREAS NOT REQUIRING SOFTFALL. ENSURE TO AS 4685
- TIMBER EDGING OR PINNED NATURAL LOGS AROUND GARDEN BEDS AS SPECIFIED IN PLAN

IRRIGATION

- INSTALL DRIP IRRIGATION WITH AUTOMATED CONTROLLER AT 300-400mm SPACING
- INSTALL ON THE ADVICE OF A QUALIFIED PROFESSIONAL
- PROVIDE AS BUILT PLAN OF THE IRRIGATION SET OUT TO THE SCHOOL AT COMPLETION OF WORKS.



OUTDOOR PLAYSACE DESIGN

PLAYFORD COLLEGE
24 DURRINGTON ROAD
ELIZABETH 5112 SA

PLANTING PLAN
DWG NO: 039-03
14.05.2020

RACHEL DRUMMOND
e:design@dirworklandscapes.com.au
m: 0400 887 366

DRAWINGS ARE ARTISTS IMPRESSIONS
FOR DESIGN PURPOSES ONLY. ALL
MEASUREMENTS TO BE VERIFIED ON SITE
BY CONTRACTORS

